

3/4"-16 UNF-2A  
x 5/8" MIN. THD.  
COMBO STUD  
1/8"-27 NPTF  
AIR FITTING  
(INSIDE)

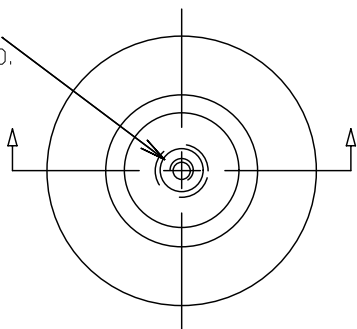

TOP VIEW

TOP AND BOTTOM  
SURFACE TO BE  
FULLY SUPPORTED  
TO 4.1" DIA.

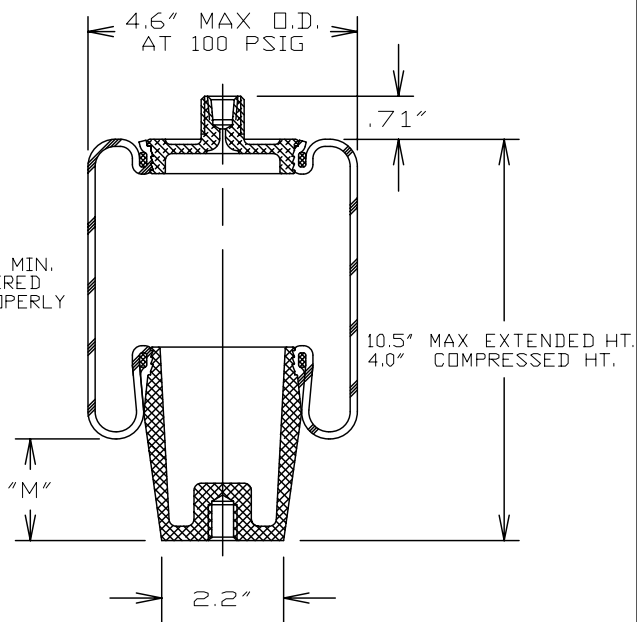

SIDE VIEW

NOTE: 10 PSIG MIN.  
PRESSURE REQUIRED  
TO OPERATE PROPERLY

1/2"-13 UNC-2B  
x 5/8" DEEP

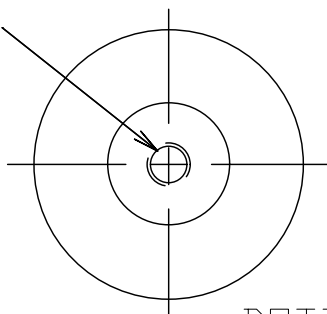

BOTTOM VIEW

ASSEMBLY NUMBER	ELASTOMER	AIR FITTING	BUMPER INCLUDED
1S4-008	WINGPRENE	1/8"-27 NPTF COMBO STUD	NO

## SPRING FEATURES:

- LOAD RANGE (ISOLATOR).....140-900 lb
- DESIGN HEIGHT RANGE (ISOLATOR).....6.5-7.5 in
- USEABLE STROKE (ACTUATOR).....6.5 in
- ASSEMBLY WEIGHT.....2.6 lb
- TEMPERATURE RANGE\*.....
- DIECAST END COMPONENTS

\* NOTE: PRODUCT LIFE MAY BE SHORTENED WHEN OPERATING AT OR NEAR EXTREME TEMPERATURES. SEE TEMPERATURE RANGE GUIDELINES SECTION.

## OTHER OPTIONS:

- COMPOSITE END COMPONENTS
- INTEGRAL QUICK CONNECT FITTINGS
- SMOOTH MOUNTING STUDS FOR USE WITH STAR CLIPS (SPEEDS ASSEMBLY)
- AIR FITTING IN PISTON
- INTERNAL RUBBER BUMPER

## RECOMMENDED MAX. TORQUE VALUES

1/2"-13 UNC BLIND TAP	3/4"-16 UNF COMBO STUD	1/8"-27 UNC AIR FITTING
360 in-lb 30 ft-lb	360 in-lb 30 ft-lb	180 in-lb 15 ft-lb

NOTE: SEE GUIDELINES FOR PROPER APPLICATION OF THIS PRODUCT

## GRAPHS FOR REFERENCE ONLY - USE THE CHART DATA BELOW FOR DESIGN WORK

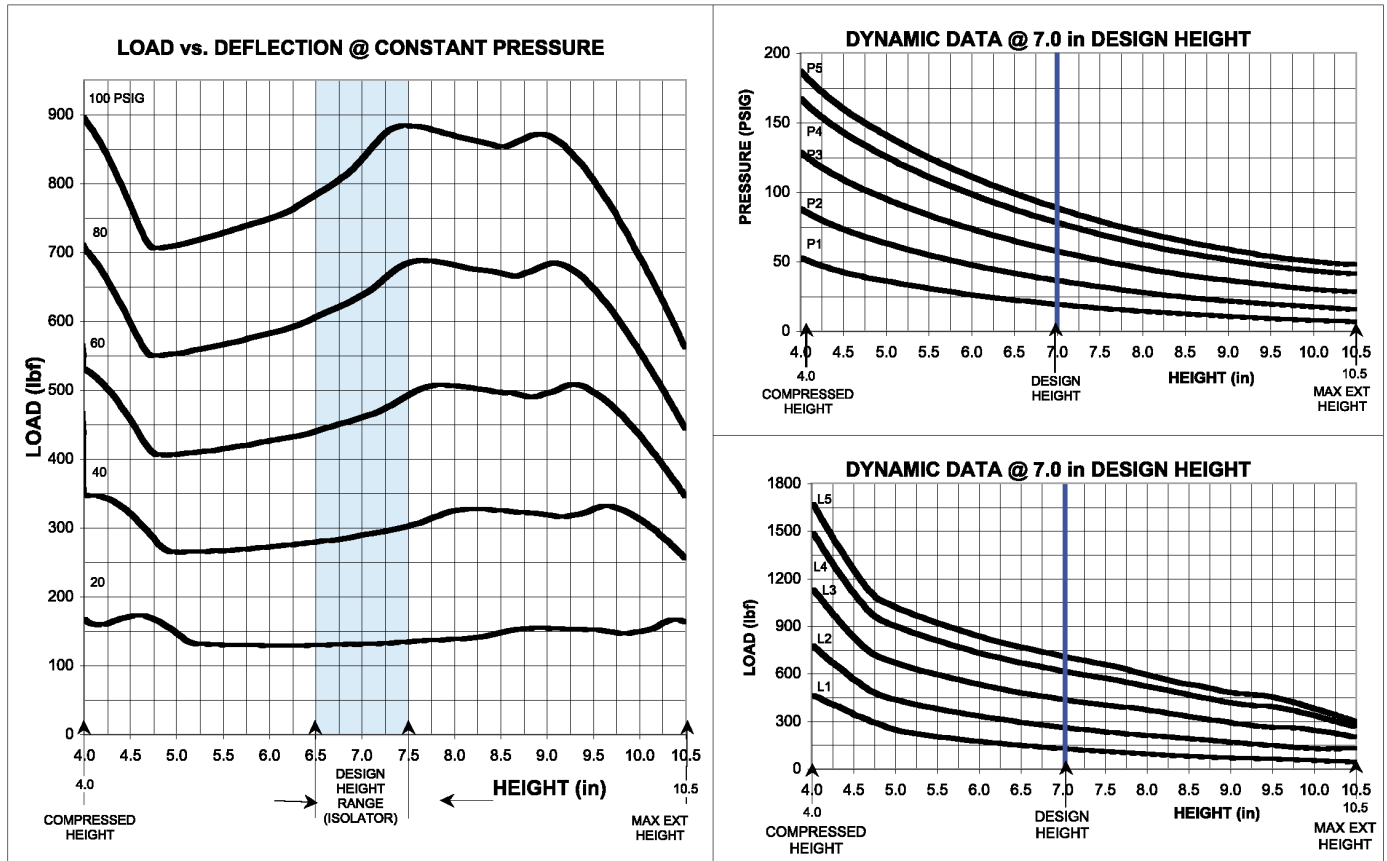

**\*\*NOTE: MAXIMUM INFLATION PRESSURE IS 100 PSIG. MAXIMUM JOUNCE PRESSURE IS 200 PSIG. IF YOUR APPLICATION WILL EXCEED THESE LIMITS, CONSULT A GOODYEAR REPRESENTATIVE FOR APPLICATION ASSISTANCE.**

### CONSTANT PRESSURE CHARACTERISTICS

Assembly Height (in)	Meniscus Height "M" Dim. @ 100 PSIG	Volume @ 100 PSIG (in <sup>3</sup> )	Nominal Force (lb)				
			@ 20 PSIG	@ 40 PSIG	@ 60 PSIG	@ 80 PSIG	@ 100 PSIG
10.5	3.3	89	140	250	340	420	540
9.0	3.1	76	160	320	520	700	850
8.0	2.4	67	150	340	520	700	850
7.5	2.1	62	150	320	520	700	900
7.0	1.8	58	140	300	480	680	900
6.5	1.4	52	140	280	460	640	800
6.0	0.9	47	130	280	440	600	750
5.0	0.2	35	150	260	420	560	700
4.5	0.1	30	180	320	460	600	750
4.0	0.0	24	170	340	520	700	850

### DYNAMIC CHARACTERISTICS

Design Height (in)	Load (lb)	Pressure (PSIG)	Spring Rate (lb/in)	Natural Frequency	
				cpm	Hz
7.5	125	19	40	99	1.65
	250	36	55	80	1.33
	425	57	105	85	1.42
	625	79	160	89	1.48
7.0	700	90	190	91	1.52
	125	21	40	97	1.62
	250	39	60	82	1.37
	425	60	70	71	1.18
6.5	625	82	95	69	1.15
	700	92	110	70	1.17
	125	21	45	103	1.72
	250	39	70	90	1.50
6.0	425	62	90	80	1.33
	625	87	105	72	1.20
	700	99	105	67	1.12
	125	21	45	103	1.72